

SQUARE SHOULDER ENDMILLS AND FACEMILLS

ENDMILLS - WELDON SHANK

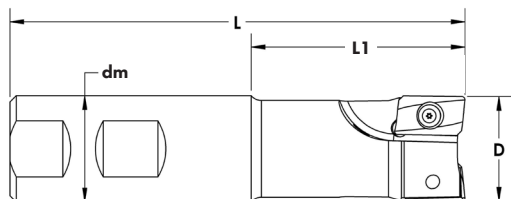

INSERT SIZE	DIAMETER D	CATALOG NUMBER	NUMBER OF INSERTS z	SHANK DIAMETER dm	OVERALL LENGTH L	NECK LENGTH L1	COOLANT THROUGH
1135	.625	SSEM0625-0750-3502	2	.750	3.50	1.47	YES
	.750	SSEM0750-0750-3502	2	.750	3.50	1.47	YES
	.750	SSEM0750-0750-3502 XL	2	.750	4.28	2.25	YES
	1.000	SSEM1000-1000-3503	3	1.000	4.30	2.02	YES
	1.000	SSEM1000-1000-3503 XL	3	1.000	5.30	3.00	YES
1604	1.000	SSEM1000-1000-6302	2	1.000	4.30	2.01	YES
	1.000	SSEM1000-1000-6302 XL	2	1.000	6.00	3.72	YES
	1.250	SSEM1250-1000-6303	3	1.000	4.30	2.02	YES
	1.500	SSEM1500-1000-6303	3	1.000	4.30	2.02	YES

FACEMILLS - ARBOR MOUNT

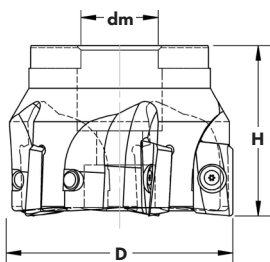

INSERT SIZE	DIAMETER D	CATALOG NUMBER	NUMBER OF INSERTS z	MOUNTING BORE DIAMETER dm	HEIGHT H	COOLANT THROUGH
1135	2.000	SSEM2000-0750-3506	6	.750	1.50	YES
1604	2.000	SSEM2000-0750-6305	5	.750	1.50	YES
	2.500	SSEM2500-0750-6306	6	.750	1.58	YES
	3.000	SSEM3000-1000-6306	6	1.000	2.25	YES
	4.000	SSEM4000-1000-6307	7	1.000	2.25	YES

NOTE: All cutters are delivered with insert mounting screws. Inserts are ordered separately.

INSERT SCREW	INSERT SIZE 1135	INSERT SIZE 1604
	NS344	NS406

250701